



TOOLS CLAMPING

Shenzhen Zeling precision industry Co., Ltd.

✉ Email: aimee.lo@precollet.com

📞 W/A, Skype, Wechat: +8618400145085

🌐 www.precollet.com

CONTENTS

IER Collet DIN6499(ISO115488)

IISK Collet

IIIDC Collet

IVNew Baby Collet(Clamping diameter: \varnothing 0.25 - \varnothing 25.4)

How to use PRECOLLET code -----ER collet



ER collet

ER08

Dimension

- 4 -

Dimension

AA

Clamping Diameter

MODEL	DIMENSION				
	D	D1	L	L1	L2
ER08	8.5	6.5	13.5	1.5	1.2
ER11	11.5	9.5	18	2.5	2
ER16	17	12.8	27.5	4	2.7
ER20	21	17.4	31.5	4.8	2.8
ER25	26	22	34	5	3.1
ER32	33	29.2	40	5.5	3.6
ER40	41	36.2	46	7	4.1

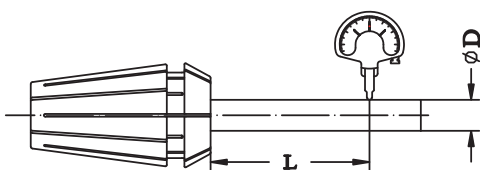
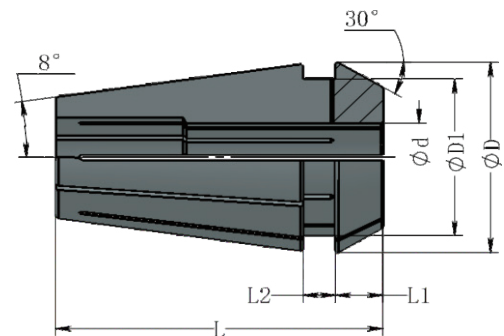

● Please specify the accuracy grade (AA or UP) when placing the order.

Inspection conditions		Runout accuracy	
D	L	AA	UP
1.0-1.4	6	0.008	0.005
1.5-2.9	10	0.008	0.005
3.0-5.9	16	0.008	0.005
6.0-9.9	25	0.008	0.005
10.0-17.9	40	0.008	0.005
18.0-26.9	50	0.008	0.005

Part No.	AA			
	Clamping Range	Available Sizes	Step Size	Permissible Clamping Capacity
ER08	0.5-5.0	1.0-5.0	0.5	0.5
ER11	0.5-7.0	1.0-7.0	0.5	0.5
ER16	0.5-4.0	1.0-4.0	0.5	0.5
	4.0-10	5.0-10.0	1.0	1.0
ER20	0.5-4.0	1.0-4.0	0.5	0.5
	4.0-13	5.0-13.0	1.0	1.0
ER25	0.5-6.0	1.0-6.0	0.5	0.5
	6.0-16	7.0-16.0	1.0	1.0
ER32	1.6-7.0	2.0-7.0	0.5	0.5
	7.0-20	8.0-20.0	1.0	1.0
ER40	2.6-8.0	3.0-8.0	0.5	0.5
	8.0-26	9.0-26.0	1.0	1.0

Part No.	UP			
	Clamping Range	Available Sizes	Step Size	Permissible Clamping Capacity
ER08	2.6-5.0	3.0-5.0	1.0	0.4
ER11	2.6-7.0	3.0-7.0	1.0	0.4
ER16	3.6-10.0	4.0-10.0	1.0	0.4
ER20	3.6-13.0	4.0-13.0	1.0	0.4
ER25	5.6-16.0	6.0-16.0	1.0	0.4
ER32	5.6-20.0	6.0-20.0	1.0	0.4
ER40				

How to use PRECOLLET code -----SK collet



Inspection conditions		Runout accuracy
D	L	UP
1.0-1.4	6	0.005
1.5-2.9	10	0.005
3.0-5.9	16	0.005
6.0-9.9	25	0.005
10.0-17.9	40	0.005
18.0-26.9	50	0.005

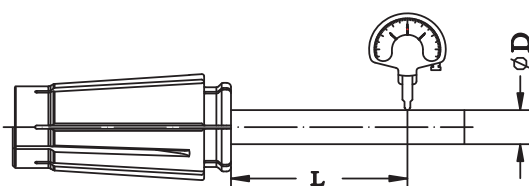
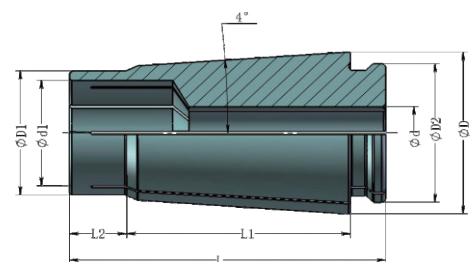

Inspection conditions		Runout accuracy
D	L	UP
1.0-1.4	6	0.005
1.5-2.9	10	0.005
3.0-5.9	16	0.005
6.0-9.9	25	0.005
10.0-17.9	40	0.005
18.0-26.9	50	0.005

Part No.	UP		
	Standard Clamping Diameter	Clamping Range	Permissible Clamping Capacity
SK6-3.0	3.00	2.75-3.00	0.25
SK6-3.175	3.175	2.925-3.175	0.25
SK6-4.0	4.00	3.50-4.00	0.5
SK6-5.0	5.00	4.50-5.00	0.5
SK6-6.0	6.00	5.50-6.00	0.5

Part No.	UP		
	Standard Clamping Diameter	Clamping Range	Permissible Clamping Capacity
SK10-3.0	3.00	2.75-3.00	0.25
SK10-3.175	3.175	2.925-3.175	0.25
SK10-4.0	4.00	3.50-4.00	0.5
SK10-5.0	5.00	4.50-5.00	0.5
SK10-6.0	6.00	5.50-6.00	0.5
SK10-8.0	8.00	7.50-8.00	0.5
SK10-10.0	10.00	9.50-10.00	0.5

Part No.	UP		
	Standard Clamping Diameter	Clamping Range	Permissible Clamping Capacity
SK13-3.0	3.00	2.75-3.00	0.25
SK13-3.175	3.175	2.925-3.175	0.25
SK13-4.0	4.00	3.50-4.00	0.5
SK13-5.0	5.00	4.50-5.00	0.5
SK13-6.0	6.00	5.50-6.00	0.5
SK13-8.0	8.00	7.50-8.00	0.5
SK13-10.0	10.00	9.50-10.00	0.5
SK13-12.0	12.00	11.50-12.00	0.5

Part No.	UP		
	Standard Clamping Diameter	Clamping Range	Permissible Clamping Capacity
SK16-4.0	4.00	3.50-4.00	0.5
SK16-5.0	5.00	4.50-5.00	0.5
SK16-6.0	6.00	5.50-6.00	0.5
SK16-8.0	8.00	7.50-8.00	0.5
SK16-10.0	10.00	9.50-10.00	0.5
SK16-12.0	12.00	11.50-12.00	0.5
SK16-14.0	14.00	13.50-14.00	0.5
SK16-16.0	16.00	15.50-16.00	0.5

Part No.	UP		
	Standard Clamping Diameter	Clamping Range	Permissible Clamping Capacity
SK20-6.0	6.00	5.50-6.00	0.5
SK20-8.0	8.00	7.50-8.00	0.5
SK20-10.0	10.00	9.50-10.00	0.5
SK20-12.0	12.00	11.50-12.00	0.5
SK20-14.0	14.00	13.50-14.00	0.5
SK20-16.0	16.00	15.50-16.00	0.5
SK20-18.0	18.00	17.50-18.00	0.5
SK20-20.0	20.00	19.50-20.00	0.5

Part No.	UP		
	Standard Clamping Diameter	Clamping Range	Permissible Clamping Capacity
SK25-6.0	6.00	5.50-6.00	0.5
SK25-8.0	8.00	7.50-8.00	0.5
SK25-10.0	10.00	9.50-10.00	0.5
SK25-12.0	12.00	11.50-12.00	0.5
SK25-14.0	14.00	13.50-14.00	0.5
SK25-16.0	16.00	15.50-16.00	0.5
SK25-20.0	20.00	19.50-20.00	0.5
SK25-25.0	25.00	24.50-25.00	0.5

How to use PRECOLLET code -----DC collet

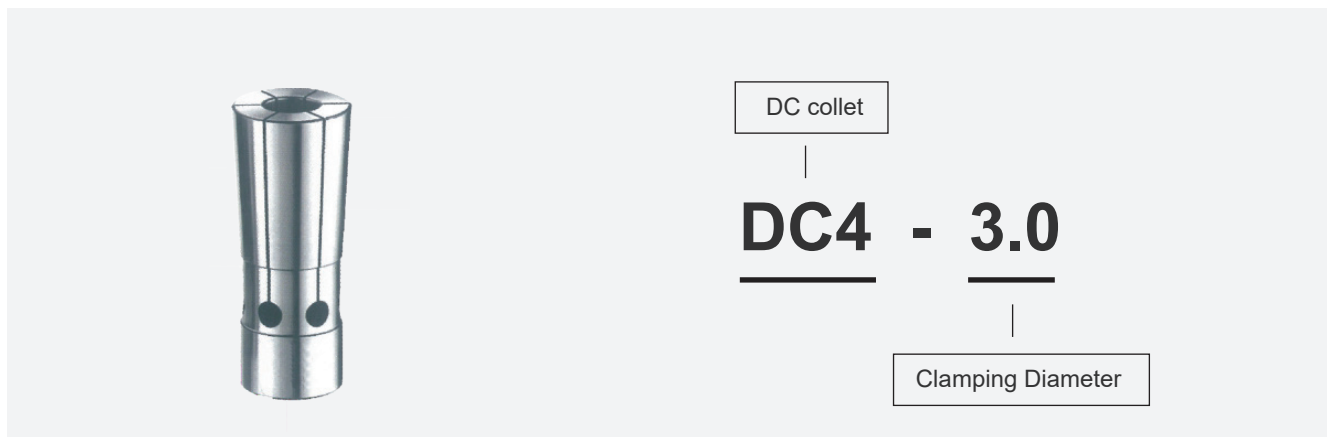

MODEL	DIMENSION			
	L	D	d	M
DC4	31	7	5.6	M4
DC6	36	9.6	8.0	M5
DC8	45	15	12.8	M6
DC10	52	19	16	M8
DC12	60	22	19	M10

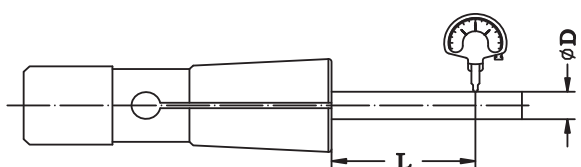
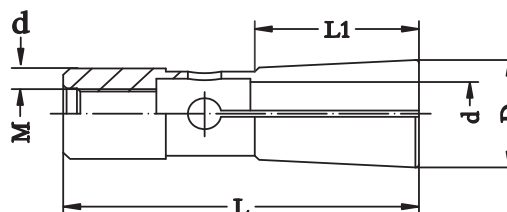

Inspection conditions		Runout accuracy
D	L	UP
1.0-1.4	6	0.005
1.5-2.9	10	0.005
3.0-5.9	16	0.005
6.0-9.9	25	0.005
10.0-12.0	40	0.005

DC COLLET



Part No.	UP
	Standard Clamping Diameter
DC4-2	2.00
DC4-3	3.000
DC4-3.175	3.18
DC4-4	4.00

Part No.	UP
	Standard Clamping Diameter
DC6-3	3.00
DC6-3.175	3.175
DC6-4	4.00
DC6-5	5.00
DC6-6	6.00

Part No.	UP
	Standard Clamping Diameter
DC8-3.0	3.00
DC8-4.0	4.000
DC8-6.0	6.00
DC8-8.0	8.00

Part No.	UP
	Standard Clamping Diameter
DC10-3.0	3.00
DC10-4.0	4.00
DC10-6.0	6.00
DC10-8.0	8.00
DC10-10.0	10.00

Part No.	UP
	Standard Clamping Diameter
DC12-4.0	4.00
DC12-6.0	6.00
DC12-8.0	8.00
DC12-10.0	10.00
DC12-12.0	12.00

How to use PRECOLLET code -----NBC collet

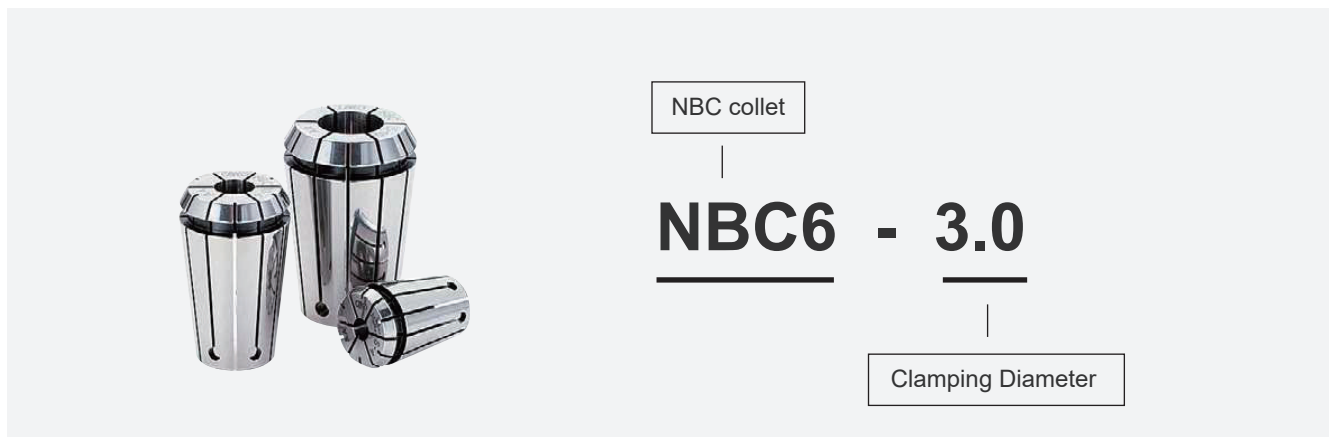

MODEL	DIMENSION	
	$\varnothing A$	B
NBC6	9.5	14
NBC8	12.5	18
NBC10	16.5	27
NBC13	20.5	31
NBC16	25.5	35
NBC20	28.5	38
NBC25	35.5	52

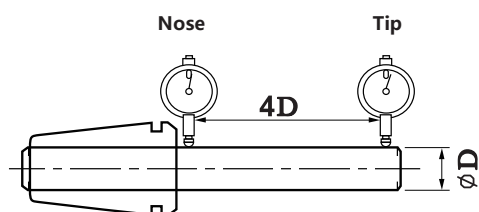
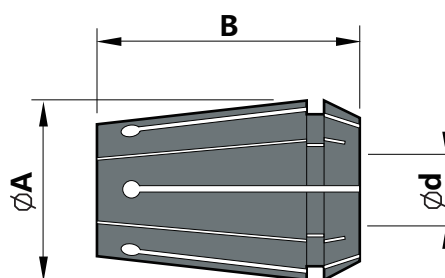

Runout accuracy	
Nose	4D
Within 2 μ m	Within 4 μ m

NEW BABY COLLET (Clamping diameter: \varnothing 0.25 - \varnothing 25.4)

Part No.	AA	
	Clamping Range	Permissible Clamping Capacity
NBC6-0.5	0.25-0.50	0.25
NBC6-0.75	0.50-0.75	0.25
NBC6-1.0	0.75-1.00	0.25
NBC6-1.25	1.00-1.25	0.25
NBC6-1.5	1.25-1.50	0.25
NBC6-1.75	1.50-1.75	0.25
NBC6-2.0	1.75-2.00	0.25
NBC6-2.25	2.00-2.25	0.25
NBC6-2.5	2.25-2.50	0.25
NBC6-2.75	2.50-2.75	0.25
NBC6-3.0	2.75-3.00	0.25
NBC6-3.175	2.925-3.175	0.25
NBC6-3.25	3.00-3.25	0.25
NBC6-3.5	3.25-3.50	0.25
NBC6-3.75	3.50-3.75	0.25
NBC6-4.0	3.75-4.00	0.25
NBC6-4.25	4.00-4.25	0.25
NBC6-4.5	4.25-4.50	0.25
NBC6-4.75	4.50-4.75	0.25
NBC6-5.0	4.75-5.00	0.25
NBC6-5.25	5.00-5.25	0.25
NBC6-5.5	5.25-5.50	0.25
NBC6-5.75	5.50-5.75	0.25
NBC6-6.0	5.75-6.00	0.25

Part No.	AA	
	Clamping Range	Permissible Clamping Capacity
NBC8-0.75	0.50-0.75	0.25
NBC8-1.0	0.75-1.00	0.25
NBC8-1.25	1.00-1.25	0.25
NBC8-1.5	1.25-1.50	0.25
NBC8-1.75	1.50-1.75	0.25
NBC8-2.0	1.75-2.00	0.25
NBC8-2.25	2.00-2.25	0.25
NBC8-2.5	2.25-2.50	0.25
NBC8-2.75	2.50-2.75	0.25
NBC8-3.0	2.75-3.00	0.25
NBC8-3.175	2.675-3.175	0.5
NBC8-3.5	3.00-3.50	0.5
NBC8-4.0	3.5-4.00	0.5
NBC8-4.5	4.00-4.50	0.5
NBC8-5.0	4.50-5.00	0.5
NBC8-5.25	4.75-5.25	0.5
NBC8-5.5	5.00-5.50	0.5
NBC8-5.75	5.25-5.75	0.5
NBC8-6.0	5.50-6.00	0.5
NBC8-7.0	6.50-7.00	0.5
NBC8-7.5	7.00-7.50	0.5
NBC8-8.0	7.50-8.00	0.5

NEW BABY COLLET (Clamping diameter: $\varnothing 0.25$ - $\varnothing 25.4$)

Part No.	AA	
	Clamping Range	Permissible Clamping Capacity
NBC10-1.75	1.50-1.75	0.25
NBC10-2.0	1.75-2.00	0.25
NBC10-2.25	2.00-2.25	0.25
NBC10-2.5	2.25-2.50	0.25
NBC10-2.75	2.50-2.75	0.25
NBC10-3.0	2.75-3.00	0.25
NBC10-3.175	2.675-3.175	0.5
NBC10-3.25	2.75-3.25	0.5
NBC10-3.5	3.00-3.50	0.5
NBC10-3.75	3.25-3.75	0.5
NBC10-4.0	3.5-4.00	0.5
NBC10-4.25	3.75-4.25	0.5
NBC10-4.5	4.00-4.50	0.5
NBC10-4.75	4.25-4.75	0.5
NBC10-5.0	4.50-5.00	0.5
NBC10-5.25	4.75-5.25	0.5
NBC10-5.5	5.00-5.50	0.5
NBC10-5.75	5.25-5.75	0.5
NBC10-6.0	5.50-6.00	0.5
NBC10-6.5	6.00-6.50	0.5
NBC10-7.0	6.50-7.00	0.5
NBC10-7.5	7.00-7.50	0.5
NBC10-8.0	7.50-8.00	0.5
NBC10-8.5	8.00-8.50	0.5
NBC10-9.0	8.50-9.00	0.5
NBC10-9.5	9.00-9.50	0.5
NBC10-10.0	9.50-10.00	0.5

Part No.	AA	
	Clamping Range	Permissible Clamping Capacity
NBC13-3.0	2.5-3.00	0.5
NBC13-3.175	2.675-3.175	0.5
NBC13-3.25	2.75-3.25	0.5
NBC13-3.5	3.00-3.50	0.5
NBC13-3.75	3.25-3.75	0.5
NBC13-4.0	3.5-4.00	0.5
NBC13-4.25	3.75-4.25	0.5
NBC13-4.5	4.00-4.50	0.5
NBC13-4.75	4.25-4.75	0.5
NBC13-5.0	4.50-5.00	0.5
NBC13-5.25	4.75-5.25	0.5
NBC13-5.5	5.00-5.50	0.5
NBC13-5.75	5.25-5.75	0.5
NBC13-6.0	5.50-6.00	0.5
NBC13-6.5	6.00-6.50	0.5
NBC13-7.0	6.50-7.00	0.5
NBC13-7.5	7.00-7.50	0.5
NBC13-8.0	7.50-8.00	0.5
NBC13-8.5	8.00-8.50	0.5
NBC13-9.0	8.50-9.00	0.5
NBC13-9.5	9.00-9.50	0.5
NBC13-10.0	9.50-10.00	0.5
NBC13-10.5	10.00-10.50	0.5
NBC13-11.0	10.50-11.00	0.5
NBC13-11.5	11.00-11.50	0.5
NBC13-12.0	11.50-12.00	0.5
NBC13-12.5	12.00-12.50	0.5
NBC13-13.0	12.50-13.00	0.5

NEW BABY COLLET (Clamping diameter: $\varnothing 0.25$ - $\varnothing 25.4$)



Part No.	AA	
	Clamping Range	Permissible Clamping Capacity
NBC16-3.0	2.5-3.00	0.5
NBC16-3.25	2.75-3.25	0.5
NBC16-3.5	3.00-3.50	0.5
NBC16-3.75	3.25-3.75	0.5
NBC16-4.0	3.5-4.00	0.5
NBC16-4.25	3.75-4.25	0.5
NBC16-4.5	4.00-4.50	0.5
NBC16-4.75	4.25-4.75	0.5
NBC16-5.0	4.50-5.00	0.5
NBC16-5.25	4.75-5.25	0.5
NBC16-5.5	5.00-5.50	0.5
NBC16-5.75	5.25-5.75	0.5
NBC16-6.0	5.50-6.00	0.5
NBC16-6.5	6.00-6.50	0.5
NBC16-7.0	6.50-7.00	0.5
NBC16-7.5	7.00-7.50	0.5
NBC16-8.0	7.50-8.00	0.5
NBC16-8.5	8.00-8.50	0.5
NBC16-9.0	8.50-9.00	0.5
NBC16-9.5	9.00-9.50	0.5
NBC16-10.0	9.50-10.00	0.5
NBC16-10.5	10.00-10.50	0.5
NBC16-11.0	10.50-11.00	0.5
NBC16-11.5	11.00-11.50	0.5
NBC16-12.0	11.50-12.00	0.5
NBC16-12.5	12.00-12.50	0.5
NBC16-13.0	12.50-13.00	0.5
NBC16-13.5	13.00-13.50	0.5
NBC16-14.0	13.50-14.00	0.5
NBC16-14.5	14.00-14.50	0.5
NBC16-15.0	14.50-15.00	0.5
NBC16-15.5	15.00-15.50	0.5
NBC16-16.0	15.50-16.00	0.5

Part No.	AA	
	Clamping Range	Permissible Clamping Capacity
NBC20-3.0	2.5-3.00	0.5
NBC20-3.25	2.75-3.25	0.5
NBC20-3.5	3.00-3.50	0.5
NBC20-3.75	3.25-3.75	0.5
NBC20-4.0	3.5-4.00	0.5
NBC20-4.25	3.75-4.25	0.5
NBC20-4.5	4.00-4.50	0.5
NBC20-4.75	4.25-4.75	0.5
NBC20-5.0	4.50-5.00	0.5
NBC20-5.25	4.75-5.25	0.5
NBC20-5.5	5.00-5.50	0.5
NBC20-5.75	5.25-5.75	0.5
NBC20-6.0	5.50-6.00	0.5
NBC20-6.5	6.00-6.50	0.5
NBC20-7.0	6.50-7.00	0.5
NBC20-7.5	7.00-7.50	0.5
NBC20-8.0	7.50-8.00	0.5
NBC20-8.5	8.00-8.50	0.5
NBC20-9.0	8.50-9.00	0.5
NBC20-9.5	9.00-9.50	0.5
NBC20-10.0	9.50-10.00	0.5
NBC20-10.5	10.00-10.50	0.5
NBC20-11.0	10.50-11.00	0.5
NBC20-11.5	11.00-11.50	0.5
NBC20-12.0	11.50-12.00	0.5
NBC20-12.5	12.00-12.50	0.5
NBC20-13.0	12.50-13.00	0.5
NBC20-13.5	13.00-13.50	0.5
NBC20-14.0	13.50-14.00	0.5
NBC20-14.5	14.00-14.50	0.5
NBC20-15.0	14.50-15.00	0.5
NBC20-15.5	15.00-15.50	0.5
NBC20-16.0	15.50-16.00	0.5
NBC20-16.5	16.00-16.50	0.5
NBC20-17.0	16.50-17.00	0.5
NBC20-17.5	17.00-17.50	0.5
NBC20-18.0	17.50-18.00	0.5
NBC20-18.5	18.00-18.50	0.5
NBC20-19.0	18.50-19.00	0.5
NBC20-19.5	19.00-19.50	0.5
NBC20-20.0	19.50-20.00	0.5

NEW BABY COLLET (Clamping diameter: \varnothing 0.25 - \varnothing 25.4)

Part No.	AA	
	Clamping Range	Permissible Clamping Capacity
NBC25-16.0	15.50-16.00	0.5
NBC25-16.5	16.00-16.50	0.5
NBC25-17.0	16.50-17.00	0.5
NBC25-17.5	17.00-17.50	0.5
NBC25-18.0	17.50-18.00	0.5
NBC25-18.5	18.00-18.50	0.5
NBC25-19.0	18.50-19.00	0.5
NBC25-19.5	19.00-19.50	0.5
NBC25-20.0	19.50-20.00	0.5
NBC25-20.5	20.00-20.50	0.5
NBC25-21.0	20.50-21.00	0.5
NBC25-21.5	21.00-21.50	0.5
NBC25-22.0	21.50-22.00	0.5
NBC25-22.5	22.00-22.50	0.5
NBC25-23.0	22.50-23.00	0.5
NBC25-23.5	23.00-23.50	0.5
NBC25-24.0	23.50-24.00	0.5
NBC25-24.5	24.00-24.50	0.5
NBC25-25.0	24.50-25.00	0.5
NBC25-25.4	24.90-25.40	0.5

BE A DISTRIBUTOR

PRECOLLET®

JOIN US

PRECOLLET has many years of experience in manufacturing Clamping and Cutting tools for swiss CNC sliding head machine. Quality, Fast delivery, High cost performance, Great services.

If you want to improve your business performance, becoming our exclusive distributor is a wise choice:

PRECOLLET last products and technical share!

More flexible order fulfillment to ensure business efficiency!

Preferential distributor purchasing prices to earn higher profits!

Shenzhen Zeling precision industry Co., Ltd.

✉ Email: aimee.lo@precollet.com

📞 W/A, Skype, Wechat: +8618400145085

🌐 www.precollet.com